

NORTHERN
· LIGHTS ·
R A N C H

HOTEL INFORMATION





WELCOME TO NORTHERN LIGHTS RANCH

GENERAL INFORMATION & TIPS FOR YOUR STAY WITH US



OPENING HOURS



RECEPTION, Tel: +358 44 770 0541

Open 8:00 am – 9:00 pm

CHECK OUT is at 11:00 am. Please visit reception for check-out.



RESTAURANT, Tel: +358 44 7700540

- BREAKFAST 8:00 am – 10:30 am
- BAR MENU 12:00 pm – 10:00 pm
- DINNER 5:00 pm – 9:00 pm
- ROOM SERVICE 12:00 noon – 9:00 pm

⇒ SEE 'SERVICES' BELOW AND MENU AT THE END

- *Outside our opening hours in any urgent technical issues please call +358 44 770 0342.*
- *In any medical emergency please always call the emergency number 112.*

AREA MAP

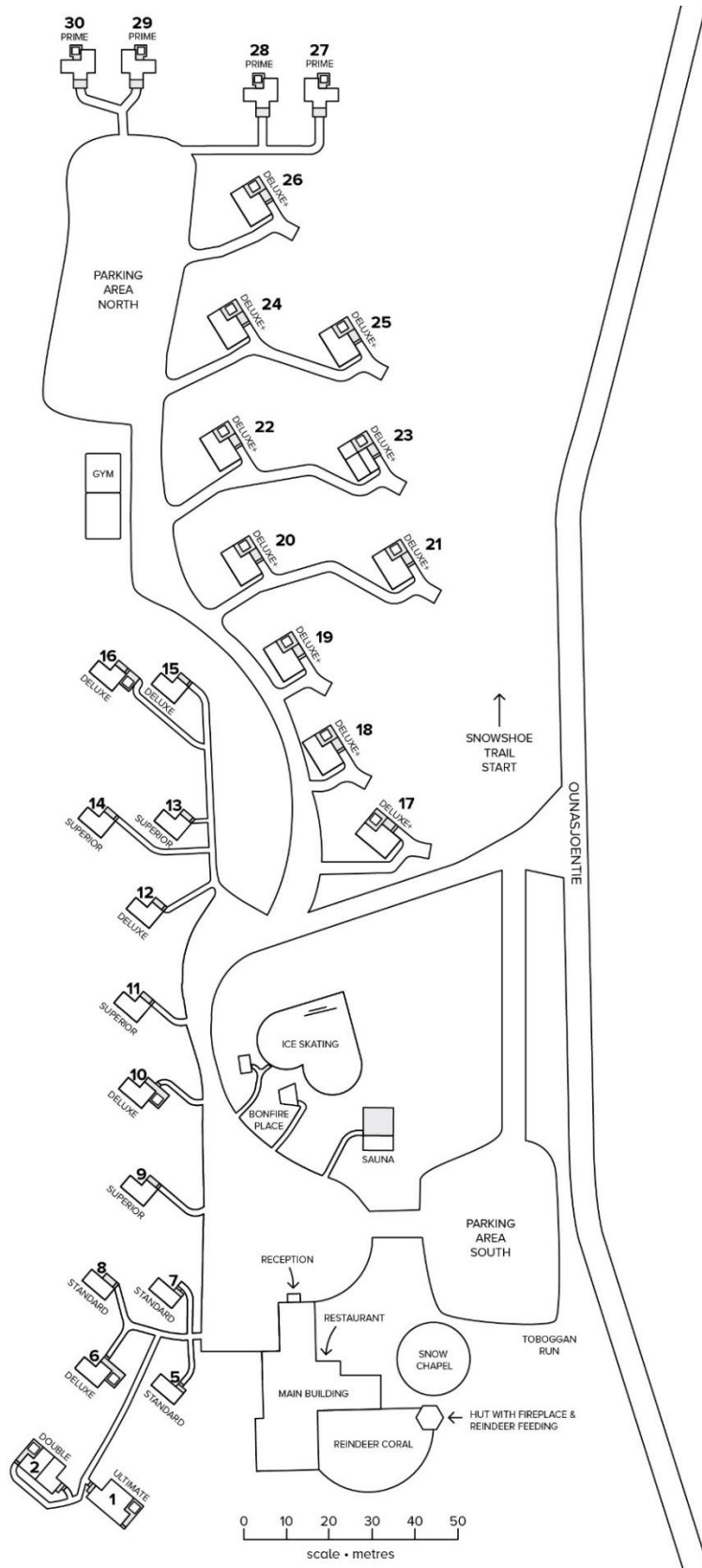

A FINNISH DOOR

HOW TO GET IN?

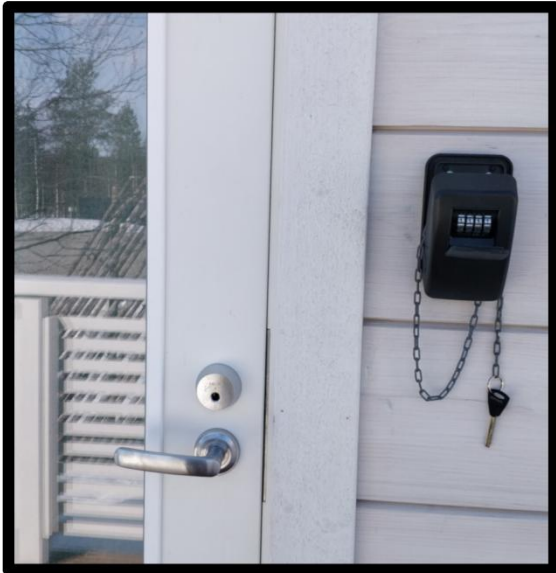

The KEY is inside the black key box:

1. Key box opens with the CODE given.
2. Enter your cabin code
3. Use the key – which is inside the box – to open the door.
4. Place the key back to the key box.
5. Close the box and swap the numbers to lock the key box

TO OPEN THE DOOR



Turn the key AND press the handle.

YOU need 2 HANDS to open
a Finnish door!

TO OPEN THE DOOR from inside

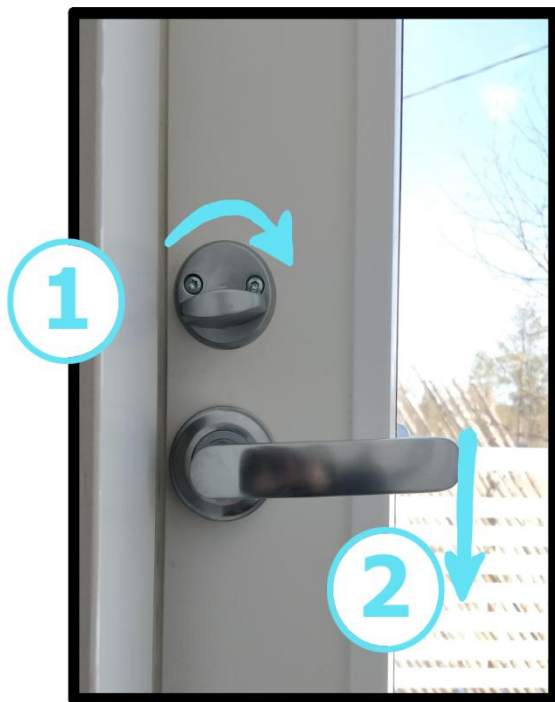

**You need 2 hands
to OPEN a Finnish door!**

Open a locked door:

Turn the lock and **with your other hand** press down the handle.

See **the arrows** in the picture.

LOCK THE DOOR:

There is a small button **in the door frame**, slide the knob upwards to lock the door.

Press the handle and slide the knob downwards and the door remains unlocked.

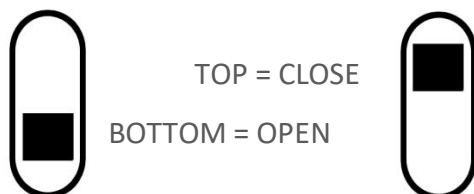

STILL LOCKED? CALL FOR ASSISTANCE:

+358 44 770 0541 (8.00 AM - 9.00 PM)

+358 44 770 0342 (9.00 PM - 8.00 AM)

YOUR CABIN

ENJOY THE COMFORT OF YOUR CABIN



HEATING

HEATING & AIRCONDITIONING

- The cabin is heated automatically by FLOORHEATING.
 - Use the **AIR CONDITIONING** for direct warmth ☀ or cooling ❄ .
- Remote can be found on the table in the kitchen.



TAKE a SHOWER

- The water boiler provides 120 litres of hot water, which permits hot showers for approximately 15-20 minutes.
- If the hot water runs out, then it takes about 1 – 1.5 hours to heat up again.



CLEANEST water & nature

We have the CLEANEST WATER DERIVING FROM THE NEARBY FELS, so it is perfectly safe and highly recommended to drink the tap water.

YOUR KITCHENETTE



If your cabin is equipped with a closed kitchenette, then the **kitchenette doors** can be opened or closed as you prefer.

TO OPEN:

- gently push in the middle of both double doors at the fold
- push the sliding doors to the narrow pockets on both sides of the kitchen
- lock the doors in the pockets with an extra push in the fold when the doors are inside the pockets

TO CLOSE:

- the double doors are in the pockets
- push at the black fold of the door to unlock the sliding system
- the door slides automatically open
- gently push in the middle of both double doors when reaching the closing position.



SLEEP WELL

You find your bed remotes – *FOR THE BEST STAR GAZING AND SLEEPING POSITION* – in the fabric pockets at both sides of the beds.



WIFI

Is **FREE to use**. Just look after the Network 'Northern Lights Ranch', and connect to it. No password needed.



AURORA FORECAST

Download the App 'Northern Lights Alert' at www.nlalert.fi.

NB! Please reduce the number of **lights in your cabin** to have the best possible northern lights experience.



SMOKING

SMOKING is strictly prohibited indoors and it applies to **ELECTRONIC CIGARETTES** as well. We charge a Penalty Fine of 250 € for smoking in the cabin.



KEY BOX

There is a key box outside the cabin. Please, keep the key always in the box. For a **lost key** there is a fine of 150 € to cover the expenses of replacement.

MINI BAR

Chocolate Bar	2.50 €
Peanuts	4.50 €
Pringles Chips	4.50 €

SPARKLING

MIONETTO PROSECCO BRUT

12 % / 20 cl, Glera, Italy 15 €

LANSON LE BLACK LABEL BRUT CHAMPAGNE

12,5 %, 20 cl, Pinot Noir, Chardonnay, Pinot Meunier France, AC
Champagne 29 €

WHITE WINE

YELLOW TAIL

11.5 %, 18.7 cl, Pinot Grigio, South Eastern Australia 15 €

RED WINE

YELLOW TAIL

13,5%, Shiraz, South Eastern Australia 15 €

BEER

Karhu Lager 4,6% 33 CL 8 €

CIDER & LONG DRINK

Crowmoor Extra Dry Apple 4.7%, 33 cl 9 €

Long Drink Grapefruit 5.5%, 33 cl 9 €

ALCOHOL FREE

Soft drink 5 €

Still or sparkling water 5 €

FINNISH STYLE HOT TUB

'PALJU'



1. Take a **SHOWER** before dipping in. Make sure that no soap, shampoo or body lotion is left on your body before entering the hot tub.



2. **BATHROBES** and **SLIPPERS** for your comfort.



3. Always warm, just lift the cover and put **COLOURFUL LIGHTS** on!



4. Please kindly place the cover over the hot tub - to keep it **WARM AND COMFY** for the next dip.

*THE FINNISH
STYLE HOT TUB*

IS CALLED

"PALJU",

IT'S A SILENT

HOT TUB

WITHOUT

BUBBLES.



NB! HOT TUB RULES

HELP US KEEP IT CLEAN!

No soap, body lotion, shampoo, drinks or food are allowed in the hot tub!

If the water would have to be changed due to not complying with the rules, then a fine of 150 € can be issued for the misuse.

Thanks a billion stars for your cooperation!

COMPLIMENTARY ACTIVITIES



SNOWSHOES

| FREE

You can find snowshoes and ski poles for complimentary use around the corner from the reception. Please return the snowshoes and ski poles to the same place after your snowshoe hike.



TOBOGGAN RUN

| FREE

You can find sledges for a toboggan run next to the hut with the fireplace and reindeer. Please return the sledges to the rack after your fun ride.



ICE-SKATING

| FREE

You can find ice-skates for complimentary use in the little hut below the bonfire place next to the ice-skating rink. Please return the ice-skates to the same place after you have finished.



FEED THE REINDEER

| FREE

You can feed our baby reindeer from the palm of your hand. Reindeer are fed mainly with hay and lichen! They love it. Lichen is available by the entrance to the restaurant. The feeding time is always in the mornings as breakfast is the most important meal of the day for the reindeer, just like us!



BONFIRE

| FREE

You are welcome to use our BONFIRE PLACE and HUT WITH FIREPLACE at any time. If you wish to make the fire by yourself, then you can ask for the matches from us or you can ask assistance from us as well.

- *A Laavu Basket can be purchased from the restaurant with marshmallows, sausages or hot drinks to be enjoyed by the bonfire.*



NORTHERN LIGHTS RANCH GYM

| FREE

Our gym is open **24/7**. We kindly ask that you use the facilities with care and show respect for the equipment, the space, and other users.

- **Door Security:** Please ensure the gym door is securely closed (but not locked) upon entering and leaving.
- **NO Outdoor Shoes** are allowed to be used in the gym.
- **Report Issues:** If you notice any equipment that isn't functioning properly or anything out of the ordinary, please inform our reception.
- **Safety First:** The gym is used at each guest's own risk. To support a safe environment, video surveillance is in place in the common areas.
- **The age limit in the gym is always 13.**

Thank you for helping us keeping the gym safe and enjoyable for all!

Please note: the use is at each person's own risk in case of accidents or breakage to the equipment. There is no liability to cover costs for broken equipment, but please kindly report the possible breakage to our staff.

ACTIVITIES BY OUR PARTNERS

We have a selection of our preferred partners' and our supplementary activities and experiences which can be found online at

www.theranchprograms.fi.



Make
your
booking
@

The most popular featured activities on the website include e.g. the following:



- Aurora Chase
- Husky Safari
- Snowmobile Safari
- Reindeer Farm Visit
- Car Hire from Northern Lights Ranch
- Sauna Facilities Rental at Northern Lights Ranch



Please note, that on the website you can only book the activities provided by our partners at a minimum 7 days in advance. However, you will find their direct contact details on the website and can make inquiries and bookings directly with them in case they would have availabilities left for your requested times.



CAR HIRE

Please remember to be on time for pickups.

The car hire from Northern Lights Ranch and renting the sauna facilities can be booked online. Details can be found later in this booklet.

Sauna



The distance to Levi Ski Resort is 15 km. There you can find a large variety of restaurants and shops, along with many great activities. Please visit www.levi.fi to find out more. See also last page for the information regarding the shuttle service and taxi transfers to/from Levi.

WWW.THERANCHPROGRAMS.FI =>

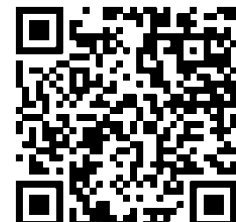

CAR HIRE FROM NORTHERN LIGHTS RANCH

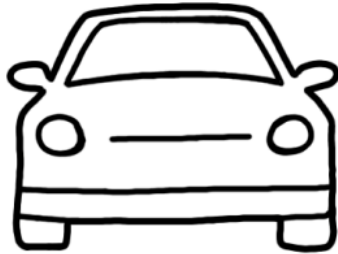

CAR HIRE

Using a rental car gives the best possibilities and most flexibility for exploring the Arctic surroundings. You can rent a Toyota Corolla with automatic transmission for daily use from Northern Lights Ranch between 15 Nov and 31 Mar as follows:

- 1 day 125 € (from 9.30 am until 8.00 am the following day)
- additional days 90 € per day

The rental fee includes 100 km per day and for additional kilometres there is a surcharge of 0.25 €/kilometre. The car is always to be returned with a tank full of gasoline. The closest gas stations can be found at Levi Ski Resort and we request to bring a receipt of the refuelling with you at the time of returning the car.

The rental time begins at 9.30 am and the car must be returned by 8.00 am on the following day. The rental agreement is signed, and the keys are collected and returned at our reception. Please note that you must have a valid driver's license with you. The personal self-liability is 1.500 € in case of accidents or theft.

BOOK YOUR PRIVATE SAUNA

WITH HOT TUB & COLD PLUNGE TUB

Quality-TIME



SAUNA

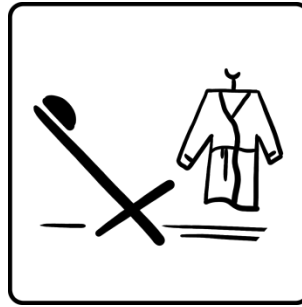

& RELAX



HOT TUB



& COLD PLUNGE TUB

Enjoy our lovely scenic sauna, outdoor hot and cold tubs as well as our comfy lounge area onsite for private hire. A truly great way to relax especially after an active day outdoors.

Duration per booking: 1.5 hours, available booking times: 1.00 pm to 2.30 pm / 3.30 pm to 5.00 pm / 6.00 pm to 7.30 pm / 8.30 pm to 10.00 pm

Price per person: Minimum fee 175 € (1 person), additional person + 25 € per person (bookings available for 1-10 persons).

Book Your Private SAUNA & Hot Tub at
WWW.THERANCHPROGRAMS.FI *or from the reception!*

SERVICES



DAY CLEANING

Between 9.00 am and 4.00 pm

To respect your privacy, we do not automatically clean your cabin daily during your stay with us.

However, we are happy to organize a complimentary daily cleaning by request. Please kindly *REQUEST THE CLEANING* and refilling of minibar, coffee / tea from the reception on the previous day.



ROOM SERVICE

We are happy to provide you with room service and to cater MEALS TO YOUR CABIN between 12.00 noon and 9.00 pm. Please note that a 30 € service charge will be added to the bill for each room service order. The menu for the room service orders can be found at the end.

Room service orders can be made from +358 44 770 0540



PARKING SPACE

After unloading your luggage, you can PARK your CAR at the two parking lots (see area map) during your stay with us and those are complimentary to use. If you have an electric vehicle, then please contact the reception for more information and pricing for charging stations.

YOUR PRIVACY

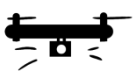

DRONE

If you have a drone you wish to use for taking photos or video material of the Northern Lights Ranch, then please note that it can only be used on the property **between 10:00 am and 8:00 pm** to respect the *PRIVACY* of other guests.

DAILY SHUTTLE OR TAXI TO/FROM LEVI & KITILÄ AIRPORT

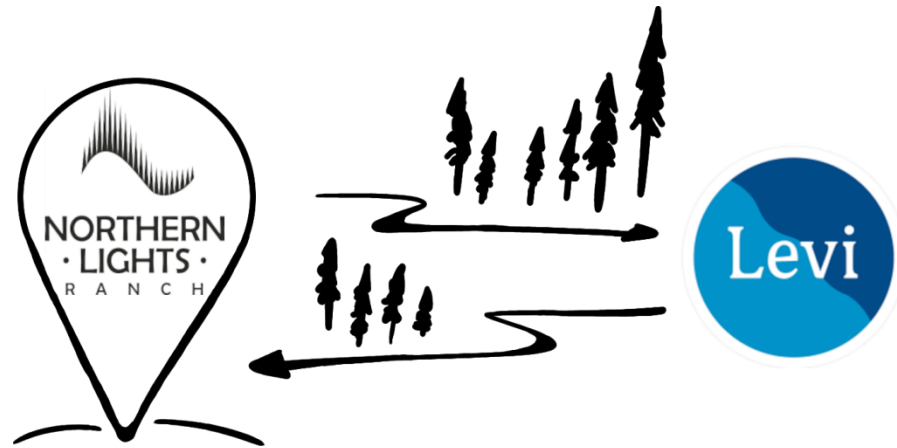

From 15 Nov to 31 Mar, we have a complimentary daily shuttle service

to Levi departing at 10.15 am.

Shuttle from Levi Info (Levi Tourist Office)

to Northern Lights Ranch Hotel is at 3.30 pm.

SHUTTLE SERVICE FOR YOU

Free of charge

Seats need to be booked at least 1 DAY beforehand

We can also order a pre-booked taxi transfer on your behalf from/to Kittilä airport for 110 €/one way and for visiting Levi Ski Resort for 65 €/one way. When departing for the airport it is recommended to depart from Northern Lights Ranch at the latest 2 hours prior to your flight departure time. Please contact the reception with your transfer requests.

ROOM SERVICE MENU

Room service orders can be catered to your cabin **daily between 12.00 noon and 9.00 pm**. Please note that a 30 € service charge will be added to the bill for each room service order. The room service orders can be placed **by calling +358 44 770 0540** and from the following selection:

Citrus Roasted Nuts & Almonds (M, GF) **5 €**

Olives with Garlic and Rosemary (M, GF) **5 €**

Side Salad, Cucumber, Tomato, Olive Oil and Balsamic Vinegar (M, GF) **6 €**

Fries and Aioli (M, GF) **7 €**

Roasted Pumpkin Soup with Sour Dough Bread and Butter (M, GF) **11 €**

Chicken Tenders, Fries and Mayo (M, GF) **18 €**

Open-Faced Sandwiches "Smörrebröd":

Elk Roast Beef, Remoulade, Roasted Onion and Granny's Cucumbers on Malt Bread (LF) **22 €**

Smoked Salmon, Horseradish Dressing, Granny's Cucumbers and Egg on Sour Dough Bread (LF) **22 €**

Swedish Meatballs, Potato Purée and Lingonberry Jam (LF, GF) **22 €**

Vegetarian Burger with a 120 g Vegetarian Patty and Cheddar Cheese Served with Fries and Mayo (LF) **24 €**

Ranch Cheeseburger with 2 x 80 g Beef Patties and Cheddar Cheese Served with Fries and Mayo (LF) **26 €**

Petit Fours **9 €**

Ice Cream, Caramel Sauce and Roasted White Chocolate (LF, GF) **10 €**

Three Cheeses, Apricots, Rhubarb Jam and Crispy Bread (LF, GF) **13 €**

LF = Lactose-free, GF = Gluten-free, M = Milk-free